

FINGERPRINT AND FACIAL RECOGNITION FOR TIME & ATTENDANCE AND ACCESS CONTROL



BIOFACE



- ▶ Color touch screen, audible voice prompts
- ▶ User photo on screen
- ▶ Facial Recognition
- ▶ Fingerprint, password, proximity card
- ▶ USB, TCP/IP
- ▶ 1:N (2.000 fingerprints and 1.200 faces)
1:1 (4.000 fingerprints and 3.000 faces)
- ▶ Bell (internal/external)
- ▶ Crystal reader without a silicone pad
- ▶ Double camera
- ▶ Simple Access Control
- ▶ Anti-dismantling button

BioFace is the most sophisticated device on the market for the control of employee time and attendance, while providing your company with a simple way to control physical access (doors). It is designed for companies with up to 3,000 employees.

With a sleek, modern, and professional design, **BioFace** is a full multimedia unit that combines a fine color touch screen with audible voice prompts for users.

When employees make a record, the device displays their photo on the screen, and it will state if the record is acceptable or not. The device is controlled through a simple and intuitive graphical menu. The main verification method for BioFace is employee facial recognition.

It has an infrared camera that will identify users even in dark environments. As an alternative, employees can log in with their fingerprint, proximity card (via an internal reader), or through a password.

The user can connect the device to the network for the online processing of records made, or transfer the records to a computer through any USB flash drive.

The high-quality fingerprint reader is made of glass without a silicone pad (readers with silicone are easily damaged), ensuring its long life.

BioFace can be connected to different devices for Simple Access Control (doors), such as locks, door sensors, doorbell buttons, opening systems, etc. When an employee is successfully verified, the device sends the signal to unlock the door.

An anti-dismantling button located on the back of the device triggers an alarm if the device is removed from the wall.

The package includes specialized software for the analysis of records. The device and software are in both English and Spanish.



FINGERPRINT AND FACIAL RECOGNITION FOR TIME & ATTENDANCE AND ACCESS CONTROL

CONNECTION DIAGRAM

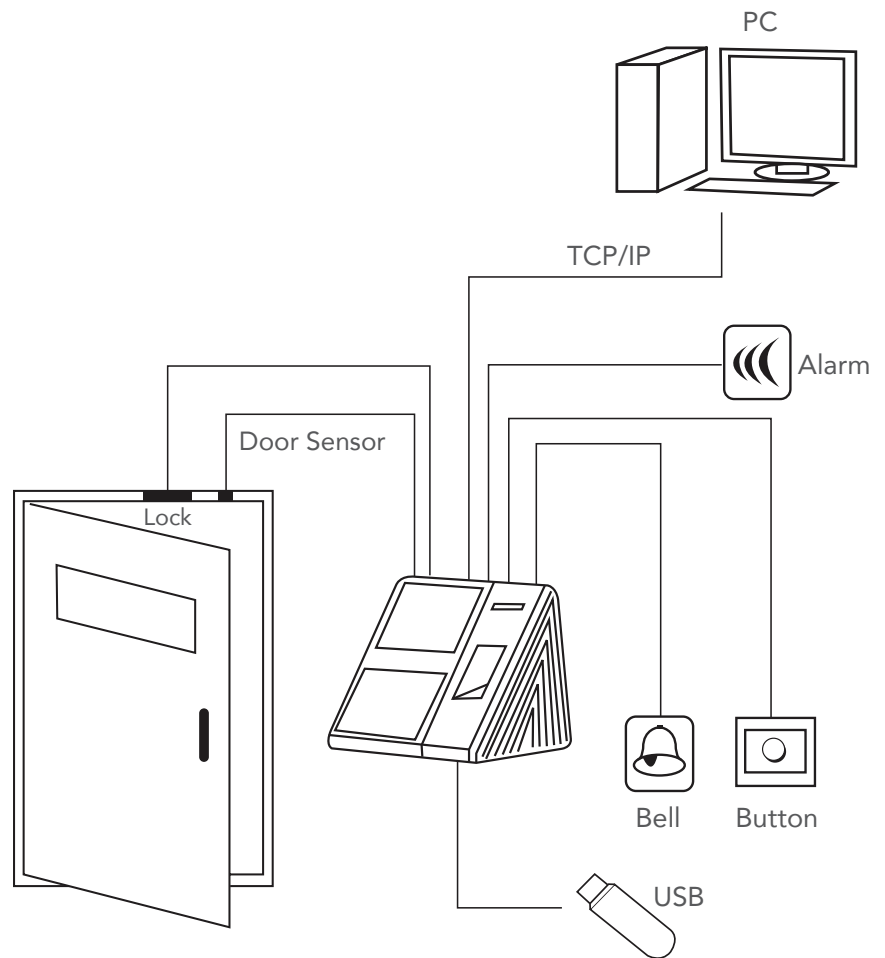

BIOFACE

Multimedia

- Color screen
- Touch screen
- Audible voice prompts
- User photo on screen

Verification Methods

- Face
- Fingerprint
- Password
- Proximity card

Connectivity

- USB
- WiFi

Others

- 3,000 fingerprints
- 700 face photos
- Bell (internal/external)
- Crystal reader without a silicone pad
- Simple Access Control (doors)
- Photographic and infrared camera
- Anti-dismantling button

SPECIFICATIONS

Screen:	Color TFT Touch 4.3"
Keyboard:	6 function keys
Capacity:	1:N (2,000 fingerprints and 1,200 faces) 1:1 (4,000 fingerprints and 3,000 faces)
Algorithm:	FRR of 0.01%, FAR of 0.0001%
Verification:	1:N
Power Supply:	12V, 3A
Dimensions:	Device: 19.36 x 16.52 x 8.6 cm (7.62 x 6.50 x 3.39")
Environment:	0°C to 45°C, (32°F to 113°F), humidity 20% to 80%

ADDITIONAL ACCESSORIES



MiniUPS
(4 hours)



Proximity
Cards



USB
Reader



Door Accessories

Authorized Dealer: